

**WE ARE  
THE COMPLEX**

**THECOMPLEX.IE**



**INTRODUCTION**

**WE ARE OPEN**

**WE ARE ADAPTING**

**WE ARE READY**

**WE ARE BOOKING**

**CONTACT US**

“These are Complex times. We are used to adapting. And we are resilient. Our venue is versatile and has many uses. There are three other spaces in the building for hire: a gallery, a rehearsal room and a break out space, as well as seventeen resident artist studios. It is a community where art lives. Please come and join us and make something memorable.”

**VANESSA FIELDING – ARTISTIC DIRECTOR**





**WE ARE OPEN**

**WE ARE OPEN FOR FILMING, REHEARSALS, SET  
BUILDING, THEATRE, LIVE EVENTS, CONFERENCES,  
CINEMA, ONLINE BROADCASTING, DIGITAL  
CONFERENCING, EXHIBITIONS, CAR LAUNCHES,  
IMMERSIVE EVENTS, SHOWS, SPECIAL MUSIC  
PERFORMANCES, COMPANY EVENTS, INNOVATIVE  
EXPERIENCES, BRANDED BRIEFINGS & MUCH MORE**



# A UNIQUE CREATIVE SPACE IN THE HEART OF DUBLIN'S EMERGING NEW CULTURAL AND CREATIVE QUARTER





# A UNIQUE CREATIVE SPACE IN THE HEART OF THE CITY ENERGY

The Complex is a dynamic arts centre that presents the work of both emerging and established artists, while offering a welcoming and inclusive space. Its unique warehouse aesthetic provides a blank canvas for arts of all kinds for both in house and visiting artists. It is also home to 17 artist studios and several community engagement initiatives, such as The Browbeating Project, The Complex Women's Drama Group, High Hopes Choir and Complex Youth Theatre. Located in the heart of north west Dublin, The Complex aims to enrich our community with art of meaningful social value.





# WE ARE ADAPTING





# THE SHOW GOES ON

These unique times call for original approaches and we are ready to thrive in these challenging times. Our ambitious and energised team are ready to help you deliver brilliantly in this new reality we find ourselves.

Working consciously within the government safety guidelines, we are ready to help you, your company, business and community to put on the world class event you deserve. Yes, things are different but we are ready to entertain, inspire, enthrall, immerse, captivate, illuminate and more.

As our artist and creative workshops return to create together, our venue is bursting into life once more too.



**1 SPECIAL CITY CENTRE VENUE  
3 UNIQUE FLEXIBLE SPACES  
ALL WE NEED NOW ARE YOUR  
IMAGINATION AND AMBITION**

**MARY'S ABBEY**



**MAIN ROOM**



**THE GALLERY**



**We are already  
adapting and  
innovating to the  
new normal we all  
find ourselves and  
will continue to do  
so while delivering  
world class events  
and experiences for  
you, your teams and  
your audience**

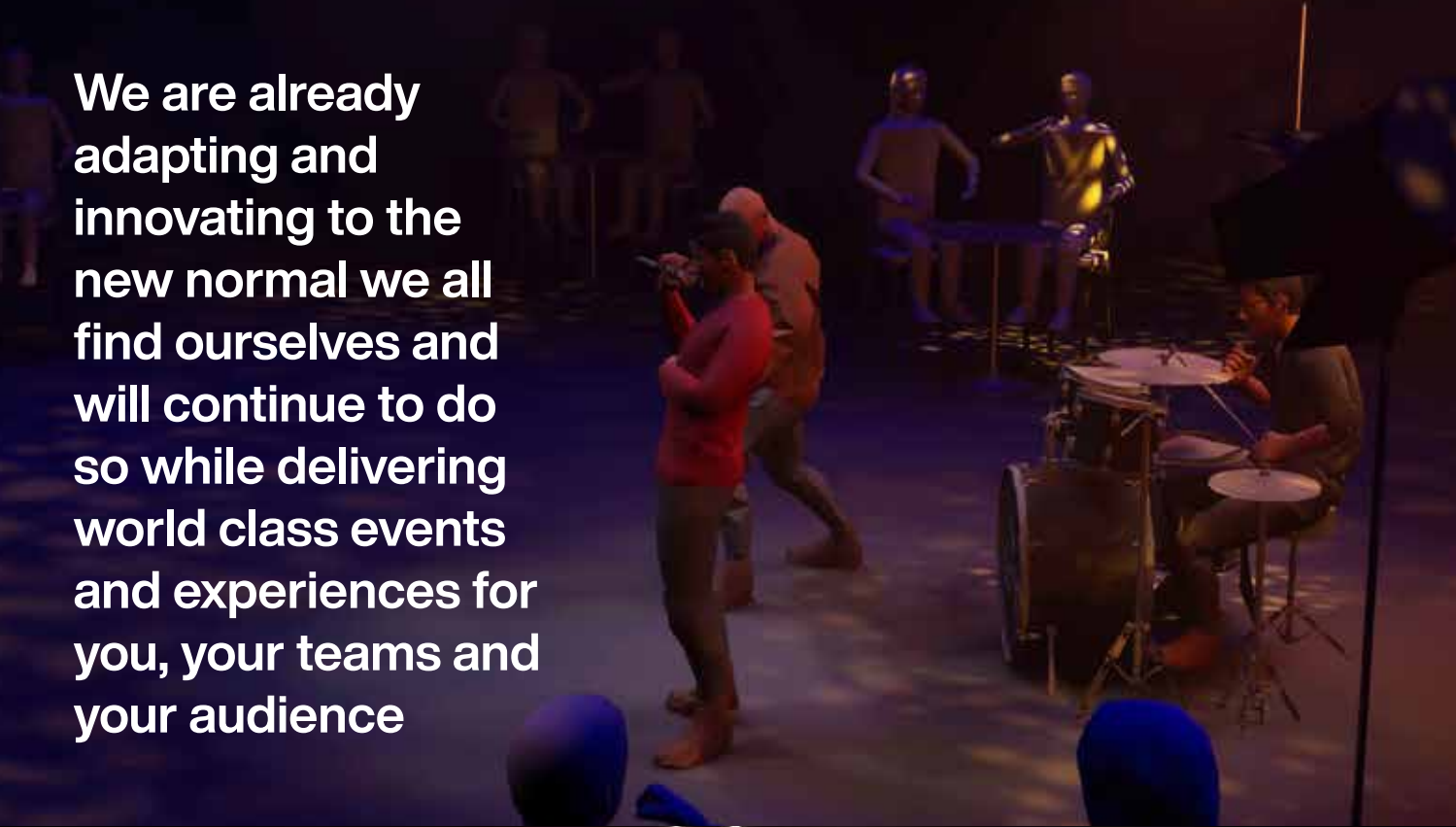



# ELECTRIC PICNIC LAUNCH







# WE ARE READY

# MAIN SPACE FLOOR PLAN

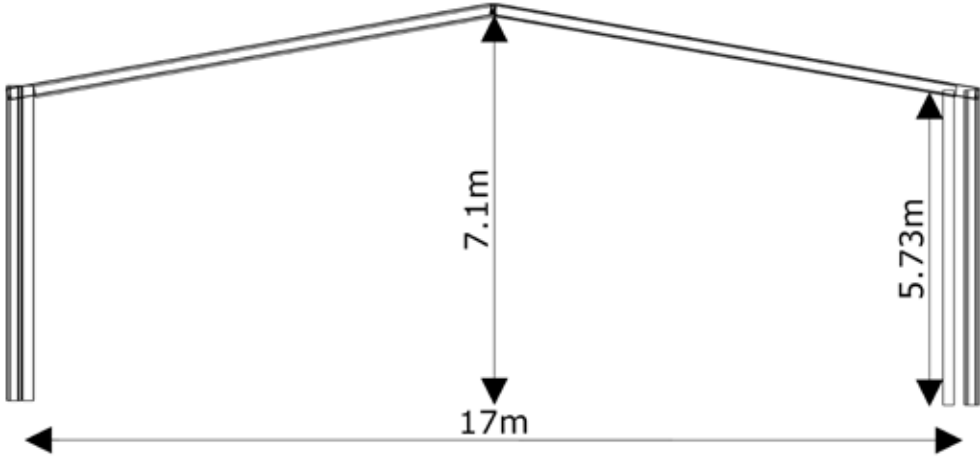
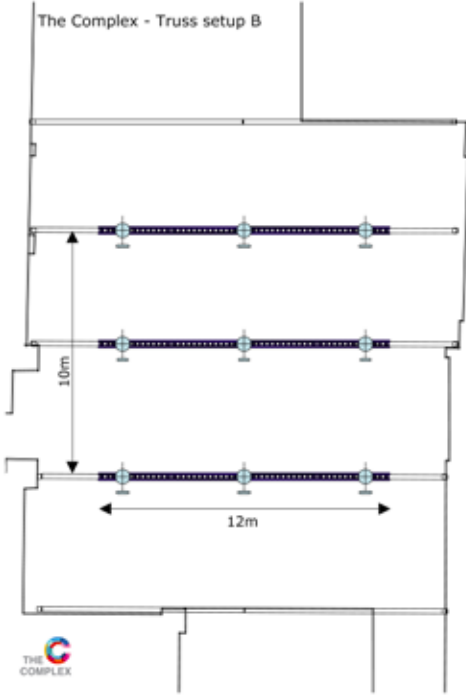
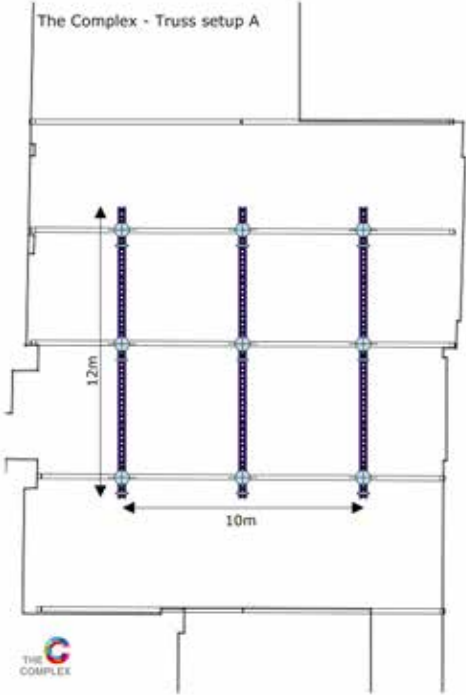
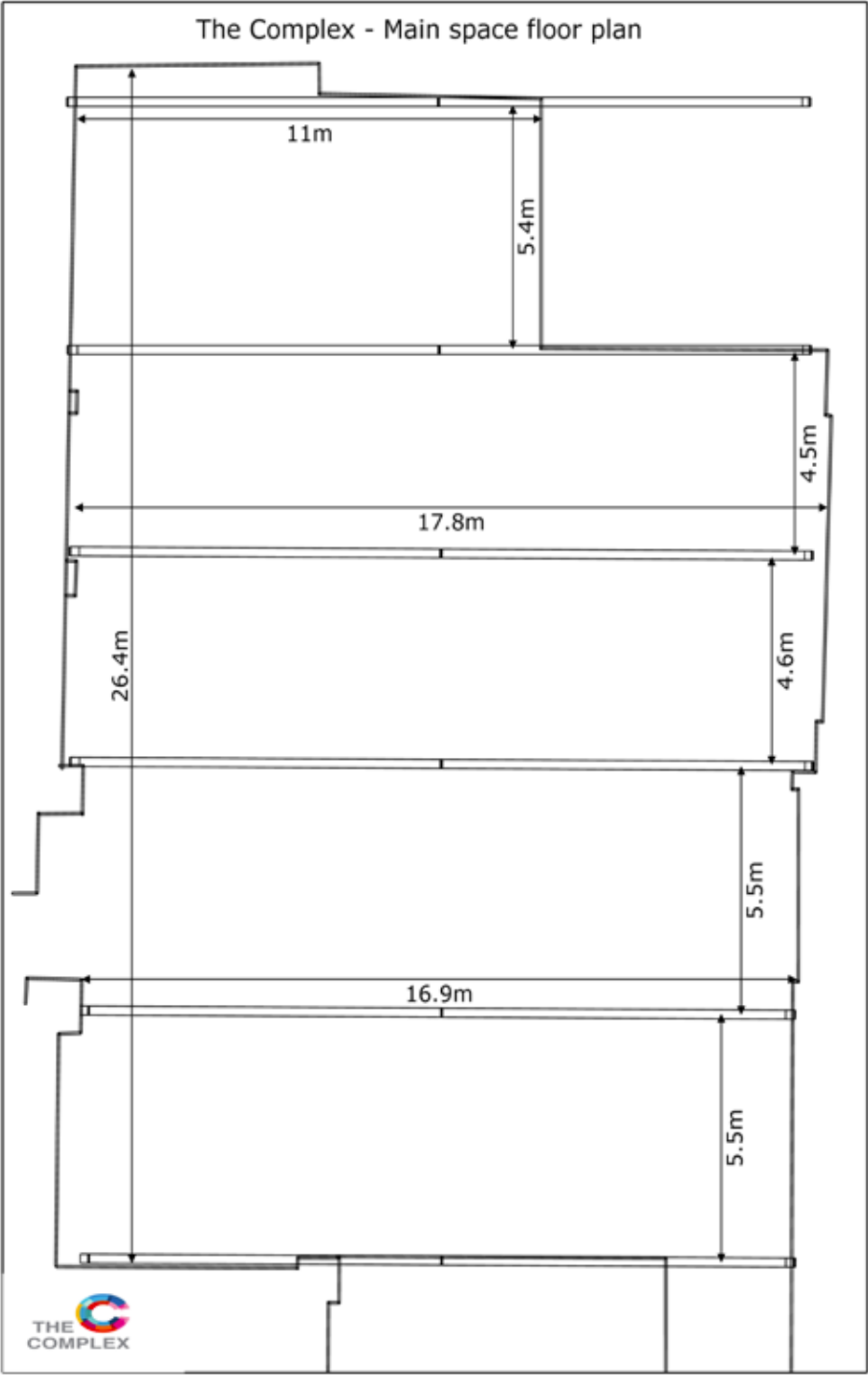



# TECHNICAL SPECS

**Technical Manager - Conor Biddle**  
technicalmanager@thecomplex.ie

## HOUSE POWER

1 x 63amp 3 phase  
1 x 32amp 3 phase  
2 x 16amp single phase  
6 X double 13amp sockets located around the venue

## VENUE DIMENSIONS MAIN SPACE

See plots below for exact venue floor plan  
Height to roof beam apex - 7.1m  
Height of side walls 5.73m  
Approx working space - 300m<sup>2</sup>

## MARY'S ABBEY

Large entrance / multi use breakout space  
Bars, reception room, cloak room etc.  
13.5m x 7.6m with 4.3m working space

## THE GALLERY

Multi use exhibition space  
venue : 10m x 9.3m with 4.9m working height.

## HOUSE PRODUCTION EQUIPMENT

Any additional equipment required can be organised by venue. We can provide full design, production and crewing for any event, please get in touch to discuss.

## STAGING

Flat concrete floor with 26 2m x 1m stage decks & legs that can be set to your specific needs

## AUDIO

2 x 12 channel desks  
Medium sized P.A  
Small mic & cable pack available

## AV

2 x projector with full Qlab / powerpoint system

## LIGHTING

1 x Strand 200 plus lighting console  
36 channels of dimming -  
6 x Zero88 Betapack 3 units  
8 x LedJ Performer 18 hex LED Parcan 6 or 10 channel mode  
36 x 1k Parcan - mixture of CP61 & CP62 lamps  
9 x Selecon RAMA 150 Fresnel 7° - 55°  
8 x Selecon SPX 25° - 50° profile  
6 x Strand SL 15° - 32° profile  
6 x Strand Cantata 18° - 32° profile  
3 x 12m trusses on 9 points  
See plots below for more details.

## SELECTION OF DRAPES ALSO AVAILABLE

Load in from street with limited short term parking.  
Please contact for load in/out timing arrangements

## OUR ADDRESS IS 14 MARY'S ABBEY, DUBLIN 7

Level access to main space via shutter 2.3 wide, 3.9m high

# WE ARE BOOKING



# BROWN THOMAS FASHION SHOW





**ALL VENUES ARE AVAILABLE TO BOOK NOW. OUR MAIN SPACE WILL OPEN FOR USE EARLY JULY AND THE GALLERY AND MARY'S ABBEY WILL BE OPEN FROM MID JUNE. WE CANNOT WAIT TO HOST YOU.**

For more information on booking, rental costs and any other questions you or your team may have, contact us at **01 537 8352 / [info@thecomplex.ie](mailto:info@thecomplex.ie)** and we will help you in every way we can.



# CONTACT US

**IF YOU HAVE AN IDEA  
YOU WOULD LIKE TO  
DISCUSS OR MAKE  
A BOOKING GET IN  
TOUCH WITH OUR  
TEAM TODAY**

## **VANESSA FIELDING**

Artistic Director  
vanessa@thecomplex.ie  
086 810 9789

## **PAUL McGRANE**

Visual Arts Coordinator  
paul@thecomplex.ie  
086 066 8979

## **CONOR BIDDLE**

Technical Manager  
technicalmanager@thecomplex.ie  
087 702 2083

## **MARK O'GORMAN**

Visual Arts Manager  
mark.ogorman@thecomplex.ie  
085 1433 858

**01 537 8352 – INFO@THECOMPLEX.IE**

# LET'S MAKE MAGIC!

**THECOMPLEX.IE**

